

DO NOT SCALE

KAGETEC GFK SYSTEM

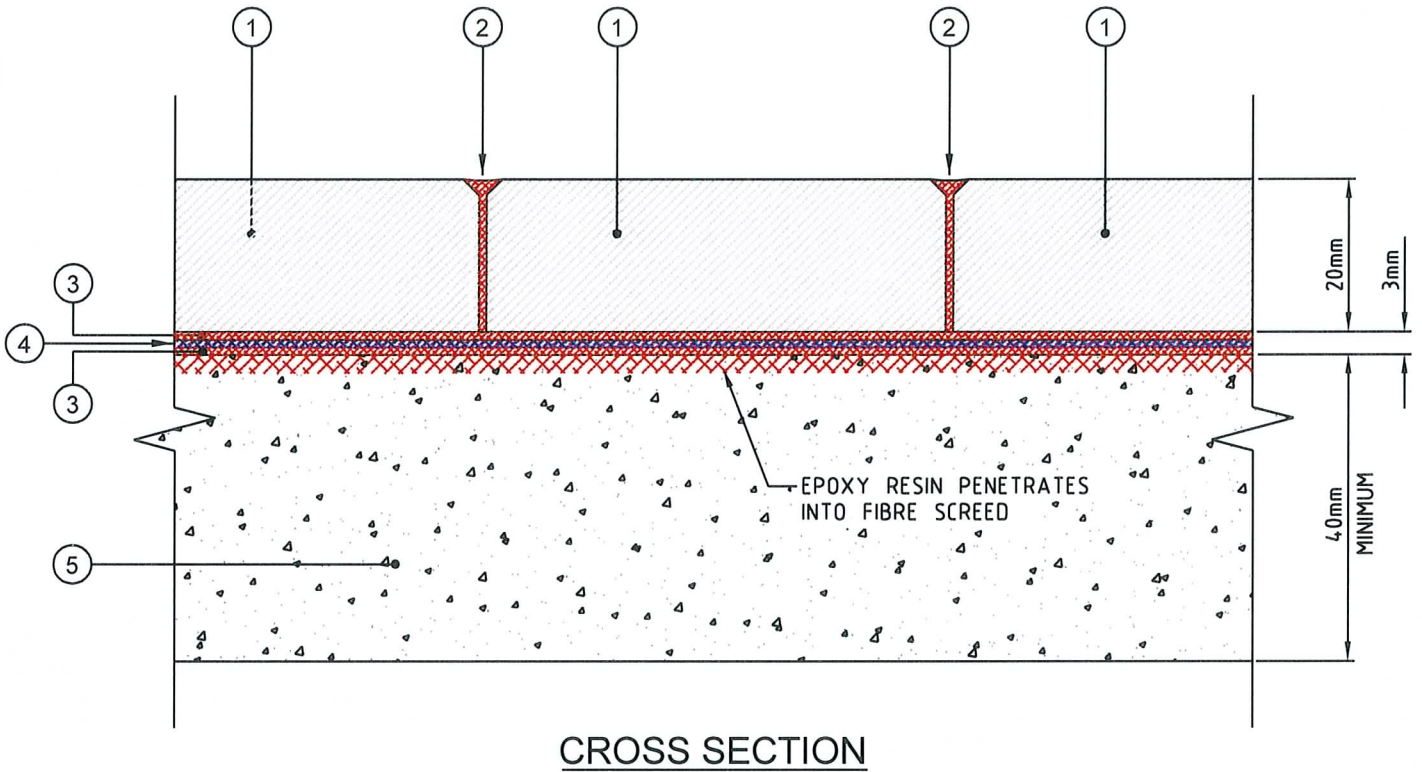

No.	DESCRIPTION
1	KAGETEC HEXAGONAL FULLY VITRIFIED TILE
2	KAGETEC EPOXY GROUT (OPTIONAL MICROBAN)
3	KAGETEC EPOXY RESIN (ADHESIVE / SEALING)
4	KAGETEC PLASTIC REINFORCING MESH
5	KAGETEC RESIN MODIFIED FIBRE SCREED



Unit C3, Taylor Business Park,
Warrington Road, Risley,
Warrington, Cheshire
WA3 6BL

Tel: 01925 763045
Fax: 01925 763381
email: all@kemtyle.co.uk
web site: www.kemtyle.co.uk

Rev	By	Description	Date
Title: KAGETEC GFK FLOOR CONSTRUCTION DETAIL			
Project:			
Client:			
Drawn By: C Halsall		Checked By: I Ferguson	
Date: 25/02/02		Date: 25/02/02	
Drg No. KTEC - 001		Scale: N.T.S. © A4	
		Rev	