

DO NOT SCALE

## KAGETEC GFK SYSTEM HEAVY DUTY GULLY SYSTEM WITH ACID RESISTANT MEMBRANE

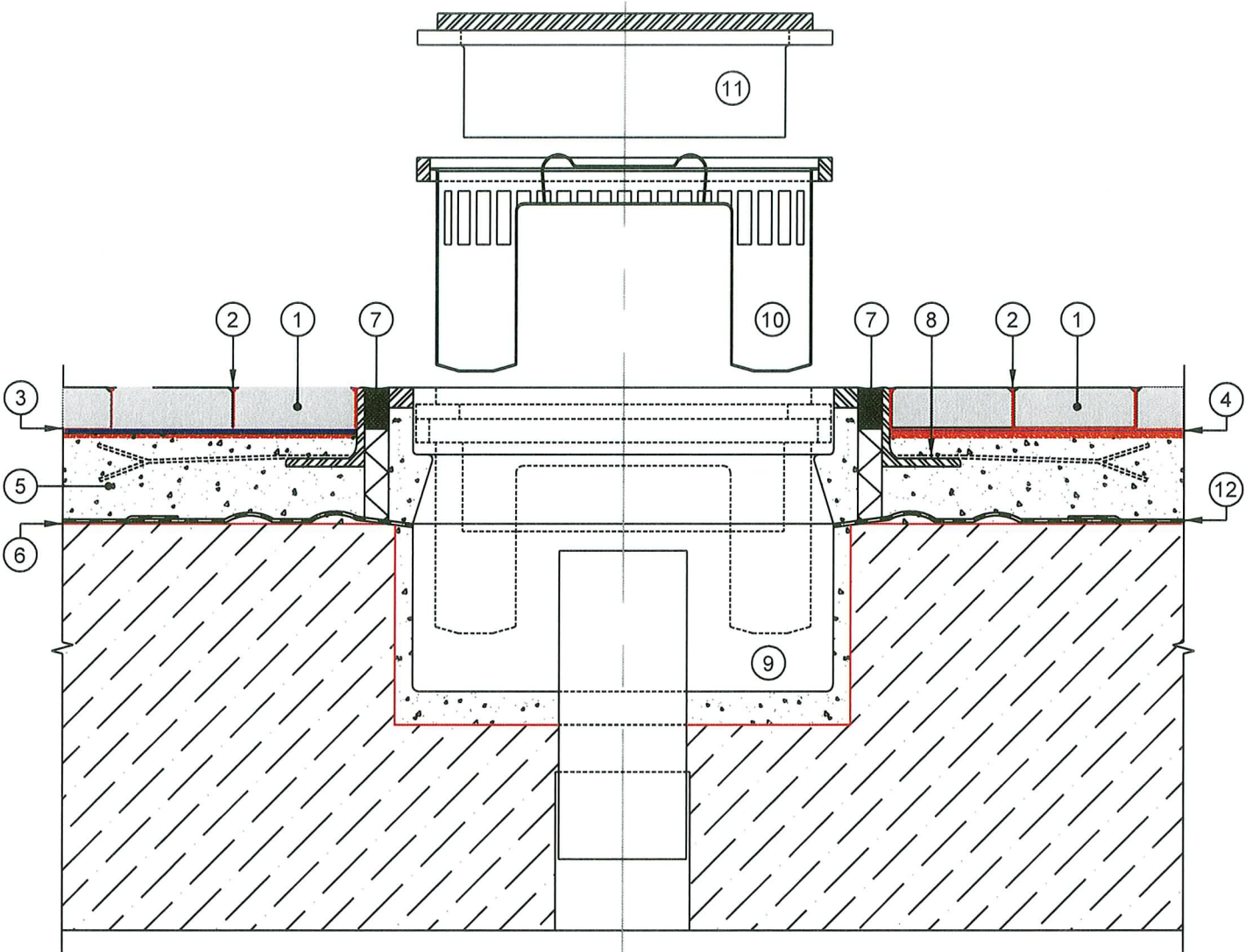

CROSS SECTION

No.	DESCRIPTION	No.	DESCRIPTION
1	KAGETEC HEXAGONAL FULLY VITRIFIED TILE	7	THERMOPLASTIC EXPANSION JOINT
2	KAGETEC EPOXY GROUT (OPTIONAL MICROBAN)	8	STAINLESS STEEL ANGLE
3	KAGETEC EPOXY RESIN (ADHESIVE / SEALING)	9	STAINLESS STEEL GULLY
4	KAGETEC PLASTIC REINFORCING MESH	10	STAINLESS STEEL SILT AND ODOUR TRAP
5	KAGETEC RESIN MODIFIED FIBRE SCREED	11	STAINLESS STEEL SILT & ODOUR TRAP GRATING
6	KAGETEC RESIN (ADHESIVE)	12	ACID RESISTANT MEMBRANE



Hygienic Flooring Solutions

Unit C3, Taylor Business Park,  
Warrington Road, Risley,  
Warrington, Cheshire  
WA3 6BL

Tel: 01925 763045  
Fax: 01925 763381  
email: [all@kemtile.co.uk](mailto:all@kemtile.co.uk)  
web site: [www.kemtile.co.uk](http://www.kemtile.co.uk)

Rev	By	Description	Date
Title: STAINLESS STEEL HEAVY DUTY GULLY DETAIL SHOWING ACID RESISTANT MEMBRANE			
Project:			
Client:			
Drawn By: C Halsall		Checked By: I Ferguson	
Date: 25/02/02		Date: 25/02/02	
Drg No. KTEC - 009			Scale: N.T.S. Ⓢ A4
			Rev